



12, Norman Terrace

£430,000

Maurepas Road, St Peter Port, GY1 2DG

LOCAL MARKET

SOLE AGENT

A smart terraced town house conveniently located near to the main amenities of St Peter Port and Admiral Park.

The accommodation comprises two bedrooms serviced by a three piece family bathroom, well equipped kitchen/diner and separate lounge.

There is a raised south facing decked area perfectly placed to enjoy the sunshine and the property is surrounded by on street parking options with further rented parking available nearby.

School catchment: Amherst Primary School / Les Varendes High School

Key facts



- Terraced town house
- Two bedrooms
- Rented and on street parking in immediate area
- Pleasant south facing rear garden
- Short distance to Town and Admiral park amenities

t 01481 236039
e enq@cooperbrouard.com
w cooperbrouard.com



 cooper
brouard

GUERNSEY'S ESTATE AGENT







Floorplan

GROUND FLOOR

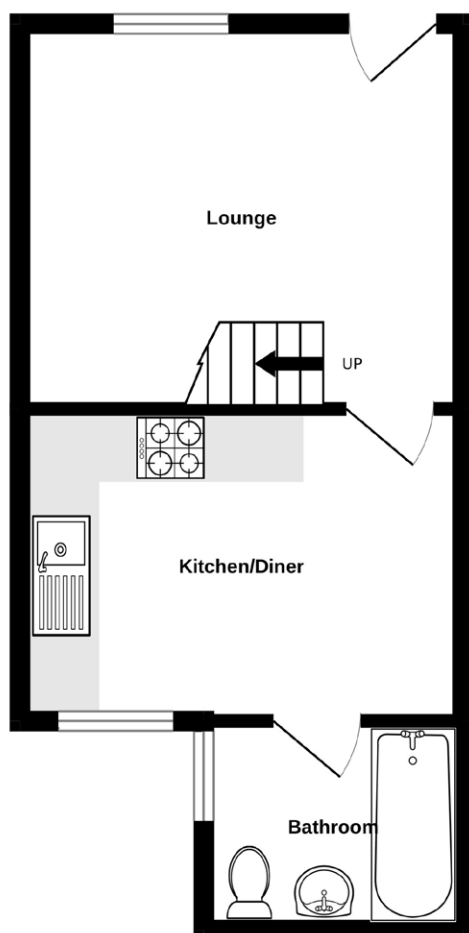

1ST FLOOR

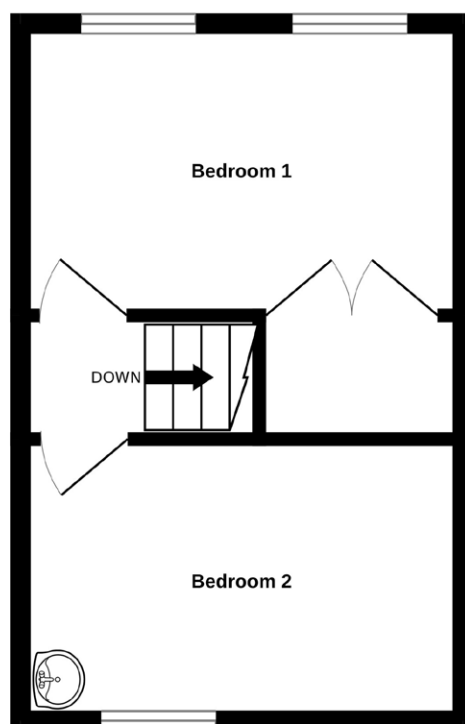

GROUND FLOOR

Lounge

12'8 x 11'8 (3.9m x 3.6m)

Kitchen/diner

12'9 x 9'7 (3.9m x 3m)

APPLIANCES

- Indesit washing machine
- Bosch tumble dryer
- Hotpoint oven
- Rangemaster hob
- Whirlpool extractor
- Samsung fridge freezer

Bathroom

6' x 5'3 (1.8m x 1.6m)

FIRST FLOOR

Bedroom 1

12'9 x 9'10 (3.9m x 3m)

Bedroom 2

12'9 x 9'4 (3.9m x 2.9m)

EXTERIOR

The front of the property is accessed via a raised walk way off the road. To the rear of the property is a low maintenance enclosed south facing decked area which provides a lovely space to enjoy the sunshine. There is a gate which leads to a rear shared pathway which leads back out onto both Amherst and Guelles Road.

Price to include: Fitted carpets, curtains, light fittings and appliances as listed.

Services: Mains electricity and water, mains drainage, gas fired central heating, uPVC double glazing.

Perry's ref: 3 G2

what3words: rook.suchlike.sweats

TRP: 93

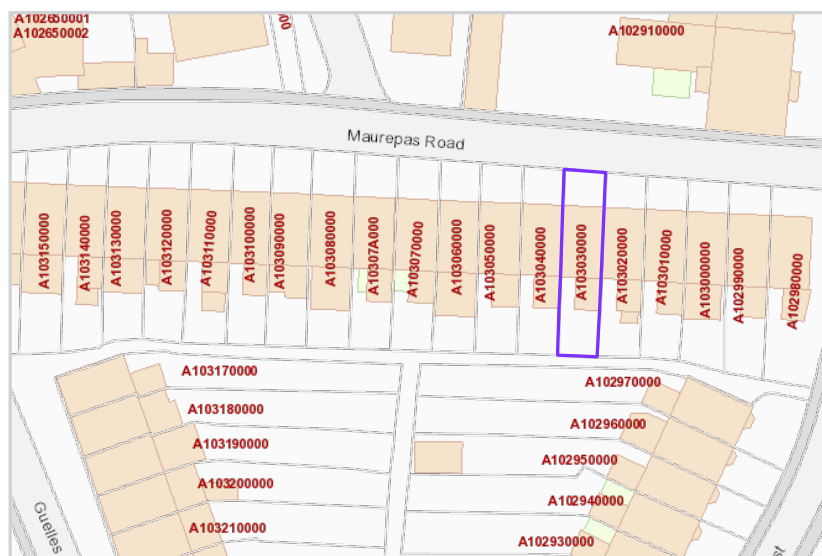

Mapping / Aerial Photography Copyright © States of Guernsey 2026

CONTACT OUR LOCAL MARKET TEAM



Matt



Ben



Liz



Courtney



Hannah



La Grande Rue,
St Martin's,
Guernsey GY4 6RR

t 01481 236039
e enq@cooperbrouard.com
w cooperbrouard.com

