



5 Grove House

Le Bordage, St Peter Port GY1 1DB

A smart, low-maintenance apartment is located within a purpose-built development in the heart of Town. The property features a good-sized kitchen with modern units and a bright, welcoming lounge.

The apartment also offers a comfortable double bedroom with built-in mirror-fronted wardrobes, making it a practical and stylish home.

£1,645pm

+ Service Charge of £45 per month

LOCAL MARKET RENTAL

SOLE AGENT

Key facts



- Smart, low-maintenance apartment within a purpose-built development in the heart of Town.
- Good-sized kitchen with modern units.
- Bright and welcoming lounge.
- Comfortable double bedroom with built-in mirror-fronted wardrobes, offering a practical and stylish home.
- Available from the 22nd May 2026

t 01481 236039
e enq@cooperbrouard.com
w cooperbrouard.com



cooper
brouard

GUERNSEY'S ESTATE AGENT





Floorplan

GROUND FLOOR

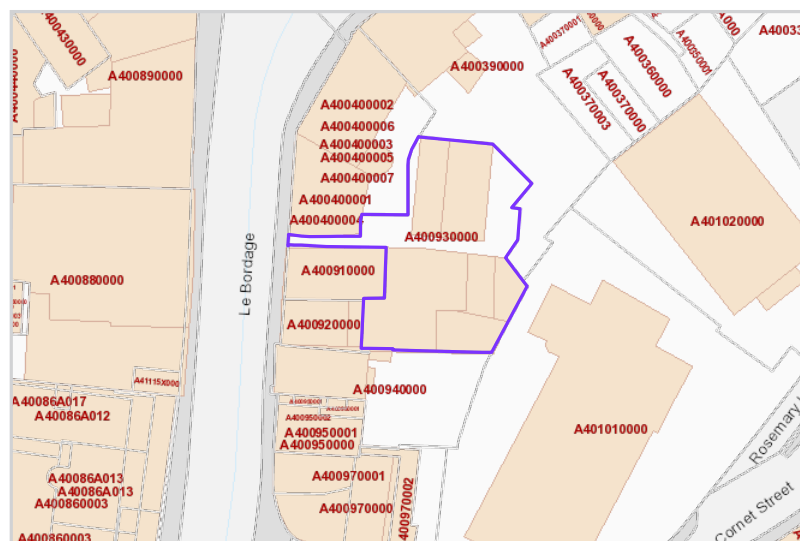
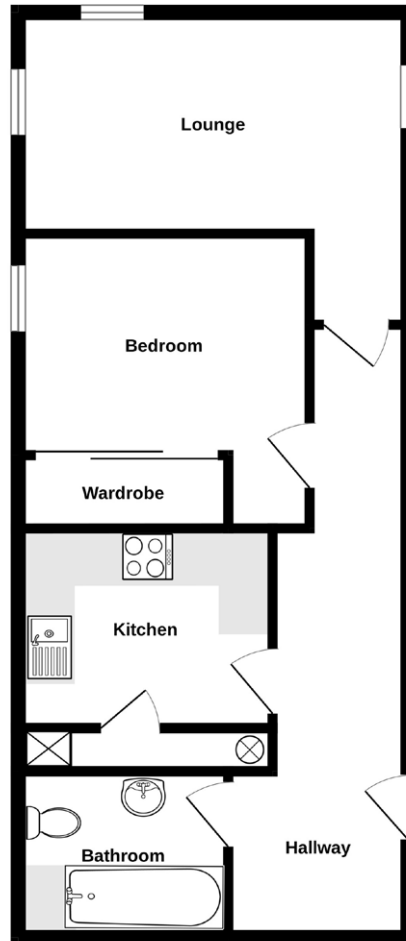

Mapping / Aerial Photography Copyright © States of Guernsey 2026

Entrance Hall

27'8 x 3'9 (8.43 m x 1.14 m)

Bathroom

6'9 x 6'7 (2.06 m x 1.98 m)

Kitchen

9'9 x 9'4 (2.97 m x 2.84 m)

APPLIANCES

- Indesit Washing Machine
- Indesit Dryer
- Hotpoint Dishwasher
- Hotpoint Fridge/Freezer
- Cata Oven & Hob

Bedroom

11'4 x 11'4 (3.45 m x 3.45 m)

Lounge

15'0 x 11'2 (4.57 m x 3.40 m)

Price to include: Fitted carpets, curtains, blinds, light fittings and appliances as listed.

Services: Mains electricity, water and drainage, electric central heating, uPVC double glazing.

Finding the property: Travelling up Fountain Street, continue onto Le Bordage and Flat 7 Grove House is located on the left (up steps) before the steep Tower Hill steps.

Perry's ref: Town K9

what3words: cabbage.hedge.porch

LEASE

Term: 1 year minimum

Rent: £1,645 + Service charge of £45 per month

Deposit: Equivalent of 1½ month's rent

Available: 22nd May 2026

Lease fee: £395

Restrictions: Regret no smokers, sharers or pets.

Additional costs: Utilities bills i.e. electricity & telephone, TRP, Parish Rates and Waste Charge. Insurance on personal possessions.

Personal References: From two professional people over 21 years of age, unrelated to the prospective tenant and who have known the prospective tenant for at least three years and can vouch for the prospective tenant's good character and suitability as a tenant.

Confirmation of affordability: We will require a copy of your current contract of employment, or a suitable letter from your employers HR department, confirming your employment inclusive of salary. We also request three months bank statements.

Proof of identity: Copy or sight of passport or drivers licence and last three months bank statements.

Housing licence (if applicable): Proof that a housing licence has been granted. A housing licence will be required for each individual if the property is to be occupied by persons that are not your immediate family.

CONTACT OUR RENTALS TEAM



Cathy



Jess



Charlie



Debbie



Jill