



Cartouche

Braye Road Clos, Braye Road, Vale, GY3 5PD

£650,000

LOCAL MARKET

SOLE AGENT

Situated on a generous private corner plot, this large semi-detached property offers endless potential for renovation or extension (STPP).

Boasting a substantial driveway with ample off-road parking and a spacious layout throughout. Cartouche is tucked away at the end of a clos and enjoys both privacy and convenience.

School catchment: Vale Primary School / St Sampson's High School

Key facts



- Corner plot
- Garage and ample parking
- Lovely private garden
- Ample living space
- Convenient location
- Offering up to 3 bedrooms

t 01481 236039
e enq@cooperbrouard.com
w cooperbrouard.com



 **cooper
brouard**
GUERNSEY'S ESTATE AGENT











Floorplan

GROUND FLOOR

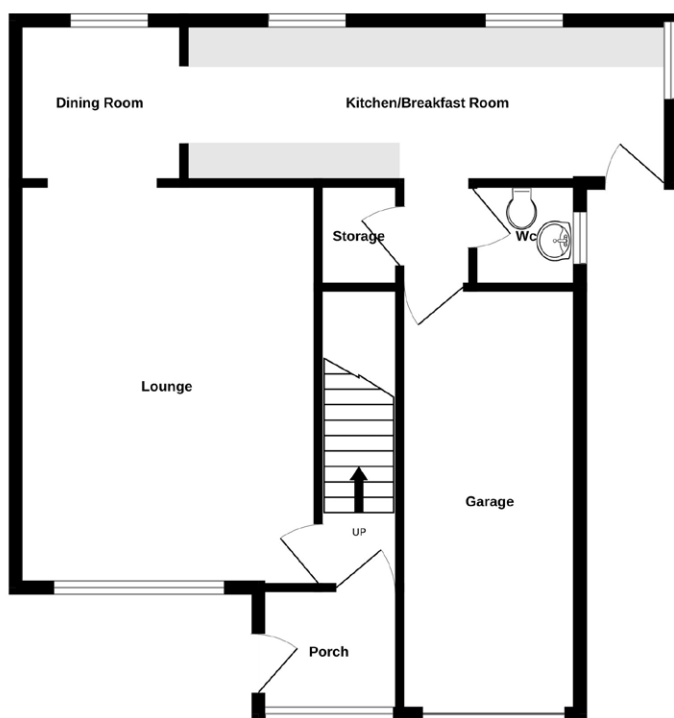

1ST FLOOR

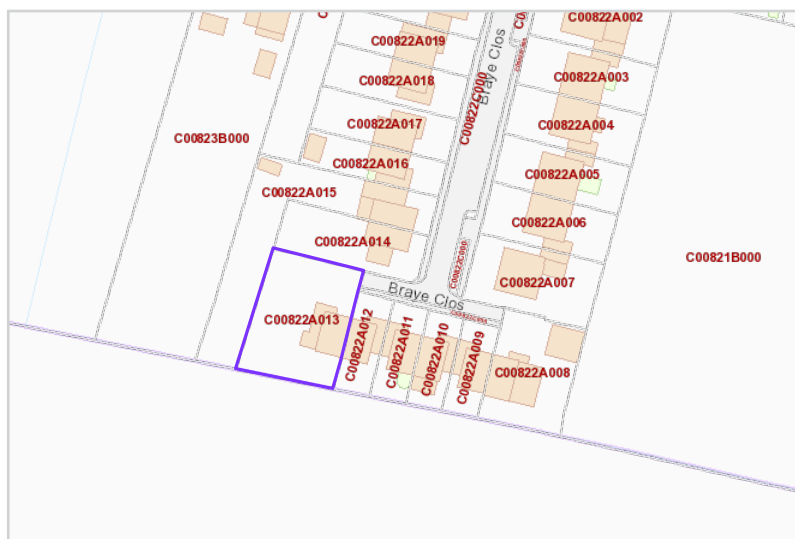
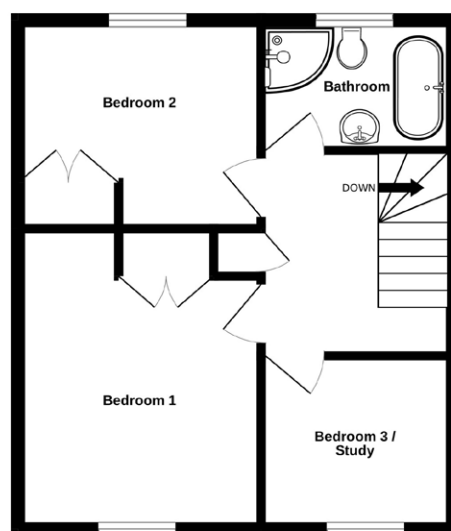

Mapping / Aerial Photography Copyright © States of Guernsey 2025

Entrance porch

6' x 5'3 (1.8m x 1.6m)

Lounge

18'6 x 13'5 (5.6m x 4.1m)

Dining room

7'2 x 6'8 (2.2m x 2m)

Kitchen

9'1 x 6'8 (2.8m x 2m)

APPLIANCES

- Hotpoint hob
- Hotpoint extractor fan
- Hotpoint oven
- Hotpoint dishwasher
- Blomberg fridge
- Blomberg freezer

Breakfast room

11'2 x 8'7 (3.4m x 2.7m)

APPLIANCES

- Bosch washing machine
- Electriq tumble dryer

WC

4'9 x 4' (1.5m x 1.2m)

Garage

16'1 x 7'7 (4.9m x 2.3m)

FIRST FLOOR

Bedroom 1

12'1 x 9'3 (3.7m x 2.8m)

Bedroom 2

10'2 x 9'5 (3.1m x 2.9m)

Bathroom

7'4 x 6'8 (2.2m x 2m)

Landing

8'6 x 7'5 (2.6m x 2.3m)

Bedroom 3 / study

9' x 7'5 (2.7m x 2.3m)

EXTERIOR

The property is approached off the clos road onto a large driveway laid to tarmac and gravel providing parking for multiple vehicles. There is an enclosed and private lawned garden with two patio areas well placed to enjoy the south west facing sunshine.

Price to include: Fitted carpets, curtains, light fittings and appliances as listed.

Services: Mains electricity and water, mains drainage, oil fired central heating, uPVC double glazing.

Clos fee: £80 to £100 per year

Perry's ref: 10 D2

what3words: ties.case.starring

TRP: 108 (+ 31 garage)

CONTACT OUR LOCAL MARKET TEAM



Matt



Ben



Liz



Courtney



Hannah



La Grande Rue,
St Martin's,
Guernsey GY4 6RR

t 01481 236039
e enq@cooperbrouard.com
w cooperbrouard.com

