



# Field at Rue des Clotures

£75,000

Ref. J013260000, Rue des Clotures, St Martins

LOCAL MARKET

SOLE AGENT

An agricultural field measuring 5 vergee and 12.49 perch, with a small furzebrake area to the south-eastern end.

Situated on an elevated site above Saint's Bay with direct access from the lane and bounded by earth banks. Currently leased on an agricultural tenancy on an annual rolling agreement with the tenant wishing to remain in situ if so desired by the new owner.

## Key facts

- Agricultural field
- Measuring 5 vergee and 12.49 perch
- Currently tenanted
- Elevated position above Saint's Bay

t 01481 236039  
e [enq@cooperbrouard.com](mailto:enq@cooperbrouard.com)  
w [cooperbrouard.com](http://cooperbrouard.com)



 **cooper  
brouard**  
GUERNSEY'S ESTATE AGENT

Perry's ref: 30 C4

what3words: ravished.rented.lines

TRP: 174

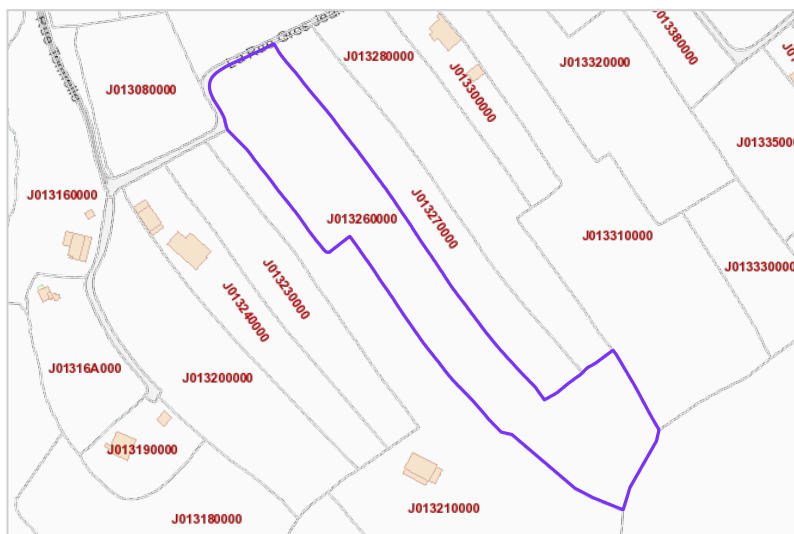

Mapping / Aerial Photography Copyright © States of Guernsey 2025

## CONTACT OUR LOCAL MARKET TEAM



Matt



Ben



Liz



Courtney



Hannah



La Grande Rue,  
St Martin's,  
Guernsey GY4 6RR

t 01481 236039  
e [enq@cooperbrouard.com](mailto:enq@cooperbrouard.com)  
w [cooperbrouard.com](https://cooperbrouard.com)



These particulars are supplied on the understanding all negotiations are conducted through this office. We understand these particulars to be correct but we do not guarantee their accuracy nor do they form part of any contract.